

# Town and Country San Diego

## Meeting & Event Space

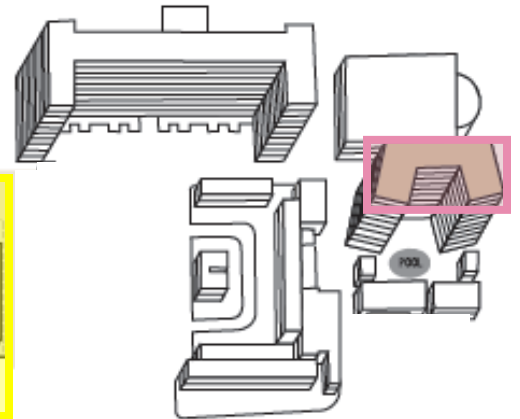
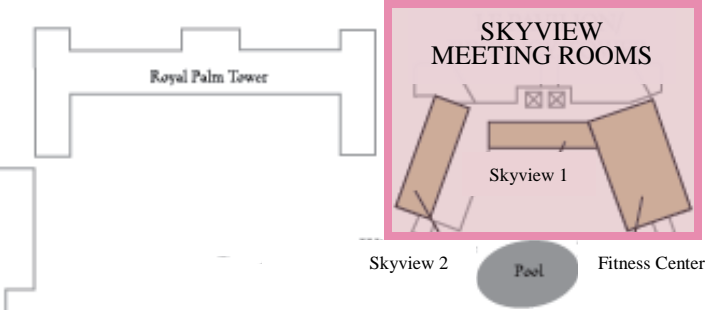
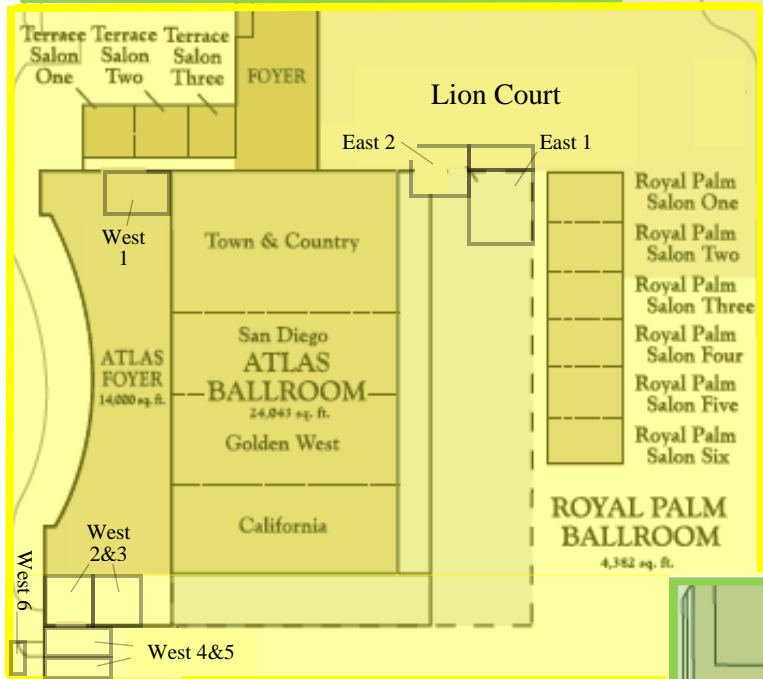

## Property Map

# Meeting Space Specifications

	Square Feet	Ceiling Height	Dimensions	Classroom	Theatre with Podium	Banquet Rounds	U-Shape	Conference	Reception	8x10 Booths	10x10 Booths
Grand Hall	40700	26'	185'x220'	2600	4600	3000			5000	263	217
Grand Hall Foyer	2800	12'	78'x35'4"						350		
Atlas Ballroom	24043	13' 9"	227'x106'	1400	2500	1710			3000	153	117
T&C Room	8904	20'	84'x106'	650	950	630	150	120	1110	53	40
San Diego	4833	13' 9"	45'8"x106'	250	440	360	120	90	500	27	20
Golden West	4833	13' 9"	45'x106'	250	440	360	120	90	500	27	20
California	4833	13' 9"	45'x106'	250	440	360	120	90	500	27	20
East Room 1 (New)	1178	11'	38'x31'	74	107	74	56	47	168		
East Room 2 (New)	1054	11'	34'x31'	66	96	66	50	42	151		
West Room 1 (New)	736	11'	23'x32'	35	41	43	27	31	82		
West Room 2 (New)	512	11'	16'x32'	24	28	30	19	21	57		
West Room 3 (New)	646	11'	19'x34'	31	36	38	24	27	72		
West Room 4 (New)	494	11'	19'x26'	24	27	29	18	21	55		
West Room 5 (New)	390	11'	15'x26'	19	22	23	14	16	43		
West Room 6 (New)	240	9'	20'x12'	12	14	14	9	10	26		
Atlas Foyer	13640	20'	182'6"x70'6"						1700		
Royal Ballroom	4382	11'	138'x31'7"	240	500	300	132	116	530		
Royal Palm 1	813	11'	25'x31'7"	40	85	50	30	48	100		
Royal Palm 2	697	11'	22'1"x31'7"	40	85	50	26	48	85		
Royal Palm 3	774	11'	24'6"x31'7"	40	85	50	26	48	90		
Royal Palm 4	695	11'	22'x31'7"	40	85	50	26	48	85		
Royal Palm 5	772	11'	24'6"x31'7"	40	85	50	26	48	90		
Royal Palm 6	631	11'	20'x31'7"	40	75	50	26	48	80		
Terrace 1	728	11' 10"	26'x28'	36	40	40	26	38	80		
Terrace 2	728	11' 10"	26'x28'	36	40	40	26	38	80		
Terrace 3	728	11' 10"	26'x28'	36	40	40	26	38	80		
Terrace 1-3	2184	11' 10"	26'x84'	100	120	130	80	90	250		
Golden Pacific Ballroom	17446	17' 9"	143'x122'	1150	2050	1350			2180	101	76
Golden Ballroom	11712	17' 9"	96'x122'	850	1450	950			1470	62	47
Pacific Ballroom	5734	17' 9"	47'x122'	300	600	384	118	100	720	30	22
Pacific 1	1927	17' 9"	47'x41'	100	200	128	48	36	240	10	7
Pacific 2	1927	17' 9"	47'x41'	100	200	128	48	36	240	10	7
Pacific 3	1927	17' 9"	47'x41'	100	200	128	48	36	240	10	7
Pacific 4	704	11' 10"	22'x32'	40	55	40	27	30	85		
Pacific 5	704	11' 10"	22'x32'	40	55	40	27	30	85		
Pacific 6	638	11' 10"	22'x29'	40	55	40	27	26	85		
Pacific 7	638	11' 10"	22'x29'	40	55	40	27	26	85		
Pacific 4&5	1408	11' 10"	44'x32'	80	120	80	42	60	175		
Pacific 6&7	1276	11' 10"	44'x29'	80	120	80	60	52	175		
Golden/Pacific Foyer	4750	12'	113'x42'						600		
Skyview 1	577	10' 6"	22'10"x17'7"	40	50	40	36	30	50		
Skyview 2	928	10' 6"	51'x18'2"	50	90	70	44	30	80		
Lion Court	6633	Outdoors	99'x67'			290			500		
Royal Palm Ballroom Lawn	4554	Outdoors	138'x33'			260			500		
Lower Level Exhibit Hall	80000	10'	Entry 16' wide	Entry 8' high							350

\*- Please note as part of our \$80 Million Property Transformation additional outdoor space will be available in the future including our new Golden Pacific Patio and three acre River Park.